

PRINCIPALS

George E. Hubbell
Thomas E. Biehl
Keith D. McCormack
Nancy M. D. Faught
Daniel W. Mitchell
Jesse B. VanDeCreek
Roland N. Alix
Michael C. MacDonald
James F. Burton

SENIOR ASSOCIATES

Gary J. Tressel
Randal L. Ford
William R. Davis
Dennis J. Benoit
Robert F. DeFrain
Thomas D. LaCross
Albert P. Mickalich
Timothy H. Sullivan

ASSOCIATES

Jonathan E. Booth
Marvin A. Olane
Marshall J. Grazioli
Donna M. Martin
Charles E. Hart
Colleen L. Hill-Stramsak
Bradley W. Shepler
Karyn M. Stickel
Jane M. Graham
Thomas G. Maxwell
Todd J. Sneathen
Aaron A. Uranga

HUBBELL, ROTH & CLARK, INC.

OFFICE: 105 W. Grand River
Howell, MI 48843
PHONE: 517.552.9199
FAX: 517.552.6099
WEBSITE: www.hrc-engr.com
EMAIL: info@hrc-engr.com

ONLINE ONLY

<http://www.hrc-engr.com/bidtabs>

ADDENDUM NO. 1

**M59 WATER MAIN CROSSING
HIGHLAND TOWNSHIP
OAKLAND COUNTY, MICHIGAN**

September 23, 2016

HRC Job No. 20130529

INTENT

This Addendum No. 1 is issued to provide changes to the Contract Documents and Drawings. The General Conditions and Specifications for the original work and the Contract Drawings are to govern this work unless otherwise revised herein.

CONTRACT DOCUMENTS

1. SECTION 00300 – PROPOSAL - (Document Revised and Reissued).
 - a. Items deleted/added/revised to match the changes in this addendum. This proposal should be submitted with the bid.

CONTRACT DRAWINGS

1. Drawing 2 – (Drawing Revised and Reissued):
 - a. Gravel road cross section has been removed and a gravel road replacement section has been added.
 - b. Trench Detail B has been added.
2. Drawing 5 – (Drawing Revised and Reissued):
 - a. Notes 1 & 5 have been revised.
 - b. Additional HDPE-DI Transition Anchors have been added.
 - c. The 16” HDPE to be directionally drilled along Milford Road south of Highland Road (M-59) has been revised to be open cut 16” ductile iron. Bid items have been revised to reflect this.
3. Drawing 6 – (Drawing Revised and Reissued):
 - a. The 8” water main has been located outside of the roadway as much as possible. Bid items have been revised to reflect this.

A copy of the amended pages of the Contract Documents noted in this Addendum No. 1 have been posted online at <http://www.hrc-engr.com/bidtabs> and should be utilized during the preparation of the bids and incorporated into the Bid Documents.



Addendum No. 1
M59 Water Main Crossing
Highland Township
September 23, 2016
HRC Job Number 20130529
Page 2 of 2

The Bidder shall acknowledge receipt of this Addendum No. 1 by signing this Addendum No. 1 and including it with the Bid Documents. Failure to submit Addendum No. 1 may result in the rejection of the bid.

Prepared by:

HUBBELL, ROTH & CLARK, INC.

Michael P. Darga
Michael P. Darga, P.E.

MPD/mpd

pc: All Bidders
Highland Twp; B. Corwin
HRC; R. Alix, N. Womack

Accepted by:

Company Name: _____

Printed Name & Title: _____

Signature: _____

Address: _____

City: _____ State: _____ Zip: _____

Telephone: _____

PROPOSAL
FOR
M-59 WATER MAIN CROSSING
HIGHLAND TOWNSHIP
OAKLAND COUNTY, MICHIGAN

Highland Township
205 N. John Street
Highland, MI 48357

Bids Due: Wednesday, September 28, 2016
On or Before 10:00 am, Local Time
HRC Job No. 20130529

To Prospective Bidders:

Name of Bidder: _____

Address: _____

Date: _____ Telephone: _____ Fax: _____

The above, as Bidder, hereby declares this bid is made in good faith without fraud or collusion with any persons bidding, and that the Drawings, Specifications, and all other information referenced in the Instructions to Bidders have been examined. Further, the Bidder is familiar with the location of the work described herein and is fully informed as to the nature of the work and the conditions relating to the performance of the Contract.

The Bidder acknowledges that no representations or warranties of any nature whatsoever have been received, or are relied upon from the Township, its agents or employees, as to any conditions to be encountered in accomplishing the work and that the bid is based solely upon the Bidder's own independent judgment.

The above, as Bidder, hereby certifies that the Drawings, Specifications, and other data provided by the Owner for bidding purposes have been examined. Further, the undersigned certifies that the proposed construction methods have been reviewed and found acceptable for the conditions which can be anticipated from the information provided for bidding.

The Bidder hereby affirms that the site of work has been inspected and further declares that no charges in addition to the Individual Unit Prices shall be made on account of any job circumstances or field conditions which were present and/or ascertainable prior to the bidding. In addition, The Contractor, as such and as Bidder, shall make the determination as to existing soil conditions and shall also complete the work under whatever conditions created by the Contractor/Bidder's sequence of construction, construction methods, or other conditions the Contractor/Bidder may create, at no additional cost to the Owner.

The above, as Bidder, confirms knowledge of the location of the proposed M-59 Water Main Crossing Project and appurtenant construction in the Township of Highland, Oakland County, Michigan, and the conditions under which it must be constructed; and also declares to have carefully examined the Drawings, Specifications, and Contract Documents which the Bidder understands and accepts as sufficient for the purpose of constructing said M-59 Water Main Crossing Project, and appurtenant work, and agrees to contract with the Township of Highland to furnish all labor, materials, tools, equipment, facilities and supervision

necessary to do all the work specified and prescribed for the Township of Highland, in strict accordance with the Owner's General Conditions, and with the full intent of the Drawings and Specifications, prepared by Hubbell, Roth & Clark, Consulting Engineers, and will accept in full payment therefore the sum of:

BASE BID

<u>Item</u>	<u>Quantity</u>	<u>Unit Price</u>	<u>Total Cost</u>
1. Pavt, Rem	710 syd	@ \$ _____	= \$ _____
2. Sidewalk, Rem	2,070 sft	@ \$ _____	= \$ _____
3. Curb and Gutter, Rem	60 ft	@ \$ _____	= \$ _____
4. Water Main, HDPE, DR 11, 16 inch, HDD	346 ft	@ \$ _____	= \$ _____
5. Water Main, DI, Cl 54, 8 inch, Tr Det A	220 ft	@ \$ _____	= \$ _____
6. Water Main, DI, Cl 54, 8 inch, Tr Det B	350 ft	@ \$ _____	= \$ _____
7. Water Main, DI, Cl 54, 16 inch, Tr Det A	207 ft	@ \$ _____	= \$ _____
8. Gate Valve & Well, 8 inch	8 ea	@ \$ _____	= \$ _____
9. Gate Valve & Well, 16 inch	4 ea	@ \$ _____	= \$ _____
10. Water Main Connection, 16 inch	1 ea	@ \$ _____	= \$ _____
11. Fire Hydrant	4 ea	@ \$ _____	= \$ _____
12. Water Service, Copper, Type K, 1 inch	105 ft	@ \$ _____	= \$ _____
13. Curb Stop and Box, 1 inch	3 ea	@ \$ _____	= \$ _____
14. HDPE to DI Transition Anchor	4 ea	@ \$ _____	= \$ _____
15. Aggregate Base, 22A	260 ton	@ \$ _____	= \$ _____
16. Aggregate Base, 21AA Limestone	270 ton	@ \$ _____	= \$ _____
17. HMA, 36A, Mod	100 ton	@ \$ _____	= \$ _____
18. HMA, 2C	30 ton	@ \$ _____	= \$ _____
19. HMA, 3C	15 ton	@ \$ _____	= \$ _____
20. HMA, 4C, Mod	15 ton	@ \$ _____	= \$ _____
21. Curb and Gutter, Conc, Det F4	60 ft	@ \$ _____	= \$ _____
22. Sidewalk, Conc, 4 inch	1,950 sft	@ \$ _____	= \$ _____
23. Sidewalk Ramp, Conc, 6 inch	120 sft	@ \$ _____	= \$ _____
24. ADA Tile, 24 inch	12 ft	@ \$ _____	= \$ _____
25. Conc, Low Temp Protection	26 cyd	@ \$ _____	= \$ _____
26. Seed, Blanket, Topsoil, 3 inch	3,800 syd	@ \$ _____	= \$ _____
27. Erosion Control, Silt Fence	300 ft	@ \$ _____	= \$ _____

28. Erosion Control, Inlet Filter	5 ea	@ \$ _____	= \$ _____
29. Mailbox, Relocate	1 ea	@ \$ _____	= \$ _____
30. Tree, Rem	4 ea	@ \$ _____	= \$ _____
31. SESC Permit Allowance	8,000 dlr	@ \$ <u>1.00</u>	= \$ <u>8,000.00</u>
32. RCOG Permit Allowance	15,000 dlr	@ \$ <u>1.00</u>	= \$ <u>15,000.00</u>
33. Traffic Control		@ Lump Sum	= \$ _____
34. Audio Video Route Survey		@ Lump Sum	= \$ _____
35. Mobilization		@ Lump Sum	= \$ _____

Total Amount of Bid \$ _____

ALTERNATES

Voluntary Alternates proposed by the Bidder will not be considered. The Bidder shall submit a bid based on the information shown on the Drawings and Specifications.

The Owner reserves the right to award the Bid depending upon the availability of funds.

The Owner, at its sole discretion, reserves the right to award to the Bidder who, in the sole determination of the Owner, will best serve the interest of the Owner. The Owner reserves the right to accept any bid, to reject any or all bids, to waive any and all informalities involving price, time, or changes in the work, and to negotiate contract terms with the successful Bidder, and the right to disregard all nonconforming, nonresponsive, unbalanced or conditional bids. However, it is the intention of the Owner to award to the low total bid to one bidder. Also, the Owner reserves the right to reject the bid of any Bidder if the Owner believes that it would not be in the best interest of the Project to make an award to that Bidder, whether because the bid is not responsive or the Bidder is unqualified, of doubtful financial ability, or fails to meet any other pertinent standard or criteria established by the Owner.

Each bidder agrees to waive any claim it has or may have against the Owner, the Architect/Engineer, and their respective employees, arising out of or in connection with the administration, evaluation, or recommendation of any bid.

Each Proposal must be accompanied by a bid deposit in the form of a certified check, cashier's check or bid bond, executed by the bidder and Surety Company, payable to the Township of Highland in the amount of Five Percent (5.0%) of the amount of the Proposal. See Instructions to Bidders – Bid Deposit for more information.

TAXES

The Bidder affirms that all applicable Federal, State and Local taxes of whatever character and description are included in all prices stated in this Form of Proposal.

ADDENDA

The Bidder acknowledges the following Addenda, covering revisions to the drawings or specifications and the cost, if any, of such revision has been included in the quoted proposal:

Addendum No. 1 Dated September 23, 2016
Addendum No. _____ Dated _____

FEES

The Bidder shall refer to the General Conditions for allowable Fees for additional work performed, upon Owner's written authorization, by Bidder's own forces and/or for additional work, upon Owner's written authorization, by Bidder's subcontractors.

TIME OF COMPLETION

If awarded the Contract for the M-59 Water Main Crossing Project, we agree to have all work substantially completed by December 30, 2016. Substantial Completion is defined that the facility is ready to use for its intended purpose with all utility systems fully functional.

The Bidder hereby agrees to furnish the required Bonds, Insurance Certificates, and Policies within ten (10) days after acceptance of this Proposal.

Final Completion with all clean-up and punch-list items shall be complete by June 1, 2017.

The execution of all work and specific constraints as described in the contract drawings and specifications, with particular reference to Section 01020 Supplemental Project Notes, must be strictly adhered to.

LIQUIDATED DAMAGES

Time is of the essence for completion of this project in order to have the Project ready for the Township of Highland. The Bidder guarantees that the work will be completed within the time limit stated herein before or within the time as extended as provided elsewhere in the Specifications. Inasmuch as the damage and loss to the Owner which will result from the failure of the Bidder to complete the work within the stipulated time, will be most difficult or impossible to accurately determine, it is mutually agreed that the damages to the Owner for such delay and failure on the part of the Bidder shall be liquidated in the amount of Six Hundred Dollars (\$600.00), for each and every calendar day by which the Bidder shall fail to complete the work or any part thereof within the provisions hereof, and such liquidated damages shall not be considered as a penalty.

The Owner will deduct and retain out of any money due or to become due hereunder the amount of the liquidated damages, and in case those amounts are less than the amount of actual liquidated damages, the Bidder shall pay the difference upon demand of the Owner.

We understand that liquidated damages may be assessed should we fail to meet the stipulated completion dates. Specifically, liquidated damages will be assessed daily beginning December 30, 2016 until such a time that Substantial Completion is achieved and further if all work is not completed by the Final Completion Date.

BIDS TO REMAIN FIRM

The price stated in this Proposal shall be guaranteed for a period of not less than 60 days from the bid due date and if authorized to proceed within that period, the bidder agrees to complete the work covered by the Proposal at said price.

If this Proposal is accepted by the Owner and the undersigned shall fail to contract as aforesaid and to furnish the required surety bonds within fifteen (15) days after being notified of the acceptance of their bid, then the undersigned shall be considered to have abandoned the contract, and the Certified Check, Cashier's Check or Bid Bond accompanying this Proposal shall be forfeited to the Township of Highland.

If the undersigned enters into the contract in accordance with their proposal, or if their proposal is not accepted, then the accompanying bid guarantee shall be returned to the undersigned.

Company Name: _____

Signature: _____ Title: _____

Printed Name: _____

Address: _____

County: _____ State: _____

Telephone No.: _____ Fax No.: _____

Email Address: _____

LEGAL STATUS OF BIDDER

This Bid is submittal in the name of:

(Print) _____

The undersigned hereby designates below the business address to which all notices, directions or other communications may be served or mailed:

Street _____

City _____

State _____ Zip Code _____

The undersigned hereby declares the legal status checked below:

- INDIVIDUAL
- INDIVIDUAL DOING BUSINESS UNDER AN ASSUMED NAME
- CO-PARTNERSHIP
The Assumed Name of the Co-Partnership is registered in the County of _____, Michigan
- CORPORATION INCORPORATED UNDER THE LAWS OF THE STATE OF _____
_____. The Corporation is
- LICENSED TO DO BUSINESS IN MICHIGAN
- NOT NOW LICENSED TO DO BUSINESS IN MICHIGAN

The name, titles, and home addresses of all persons who are officers or partners in the organization are as follows:

A corporation duly organized and doing business under the laws of the State of _____

NAME AND TITLE	HOME ADDRESS
_____	_____
_____	_____
_____	_____

Signed and Sealed this _____ day of _____, 20__.

By (Signature)

Printed Name of Signer

Title

BID BOND

We, the undersigned, _____

As Principal, hereinafter called the Principal, and _____

A corporation duly organized under the laws of the State of _____

As surety, hereinafter called the SURETY, are held and firmly bound unto:

The Owner: _____

in the sum of _____ Dollars (\$ _____),

For the payment of which sum well and truly to be made, the said Principal and the said Surety, bind ourselves, our heirs, executors, administrators, successors and assigns, jointly and severally, firmly by these presents.

WHEREAS, the Principal has submitted a bid for _____

NOW, THEREFORE, if the OWNER shall accept the bid of the Principal and the Principal shall enter into a contract with the OWNER in accordance with the terms of such bid, and give such bond or bonds as may be specified in the CONTRACT DOCUMENTS with good and sufficient surety for the faithful performance of such contract and for the prompt payment of labor and material furnished in the prosecution thereof, or in the event of the failure of the Principal to enter such contract and give such bond or bonds, if the Principal shall pay to the OWNER the difference not to exceed the penalty hereof between the amount specified in said bid and such larger amount for which the OWNER may in good faith contract with another party to perform the work covered by said bid, then the obligation of the Principal shall be null and void, otherwise to remain in full force and effect.

Signed and sealed this _____ day of _____, 20____

(Witness) (Principal) (Seal)

(Title)

(Witness) (Surety)

(Title)

END OF SECTION

TIME - 23-SEP-2016 09:13

FEW TEL - 07102015HRC2M

CUR TEL - I:\MSR\enr\gwhr\pdr\pdr.dwg

001010

DESIGN FILE - I:\201305\20130529\C\001010\102.dgn

USER NAME - jfames



HRC
HUBBELL, ROTH & CLARK, INC
 CONSULTING ENGINEERS SINCE 1915

555 HULET DRIVE P.O. BOX 824
 BLOOMFIELD HILLS, MICH. 48303-0824

PHONE: (248) 454-6300
 FAX (1st Floor): (248) 454-6312
 FAX (2nd Floor): (248) 338-2592

WEB SITE: <http://www.hrc-engr.com>

HMA APPLICATION CHART			
ITEM	RATE PER APPLICATION (PER COURSE)	PERFORMANCE GRADE	COURSE
HMA, 36A, MOD	165 LBS/SYD	PG 58-28	WEARING + LEVELING (2 COURSES)
HMA, 2C	440 LBS/SYD	PG 58-28	BASE
HMA, 3C	220 LBS/SYD	PG 58-28	LEVELING
HMA, 4C, MOD	220 LBS/SYD	PG 58-28	WEARING
HMA BOND COAT (INCLUDED IN COST OF HMA)	0.10 GAL/SYD	PG 58-28	FOR INFO ONLY (NET A PAY ITEM)

* AGGREGATE WEAR INDEX EQUALS 260

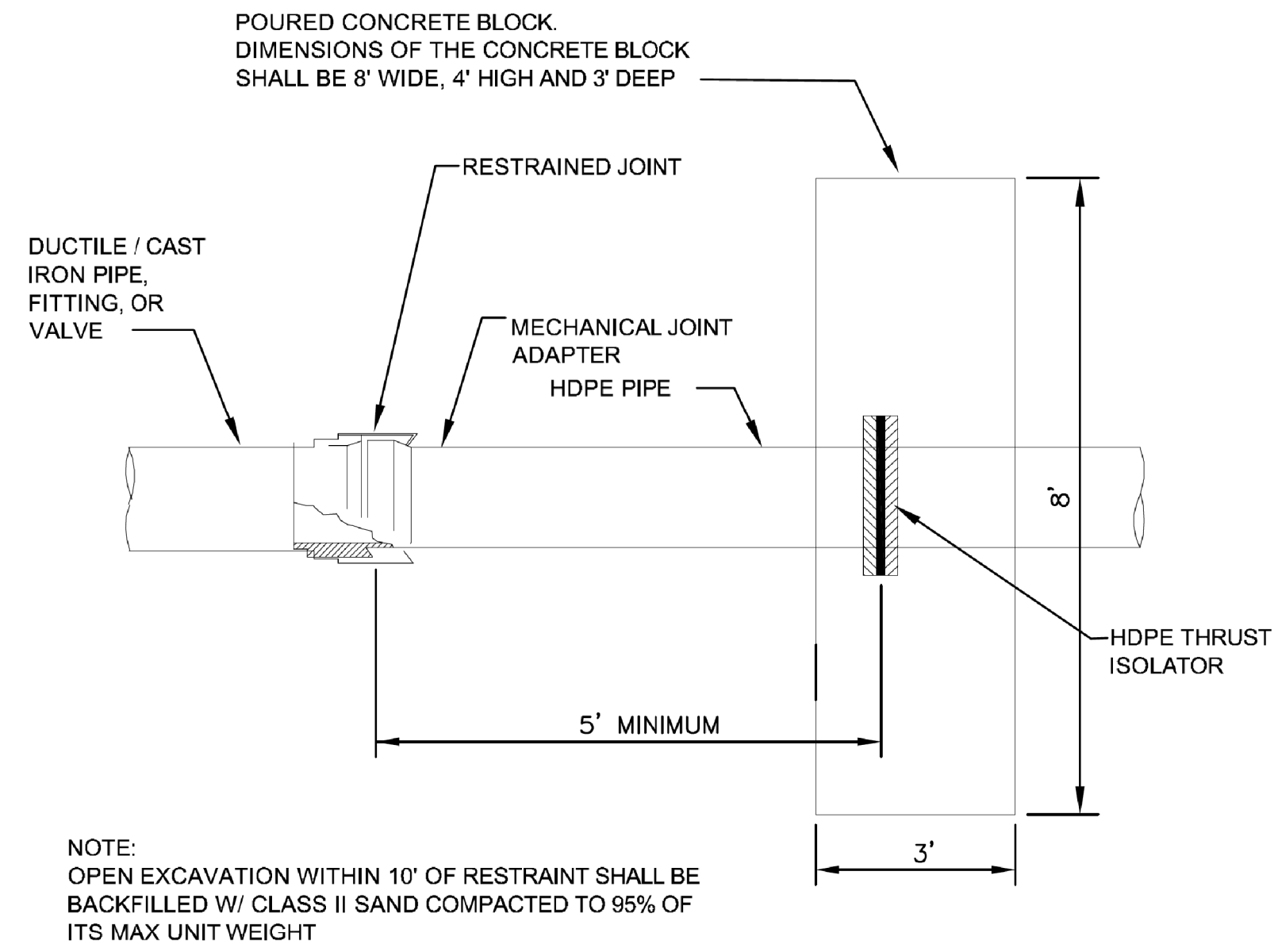

HDPE WATER MAIN MECHANICAL JOINT ADAPTER/RESTRAINT DETAIL

N.T.S.
(INCLUDED IN THE UNIT PRICE FOR WATER MAIN, HDPE, DR11, 16 INCH, HDD)

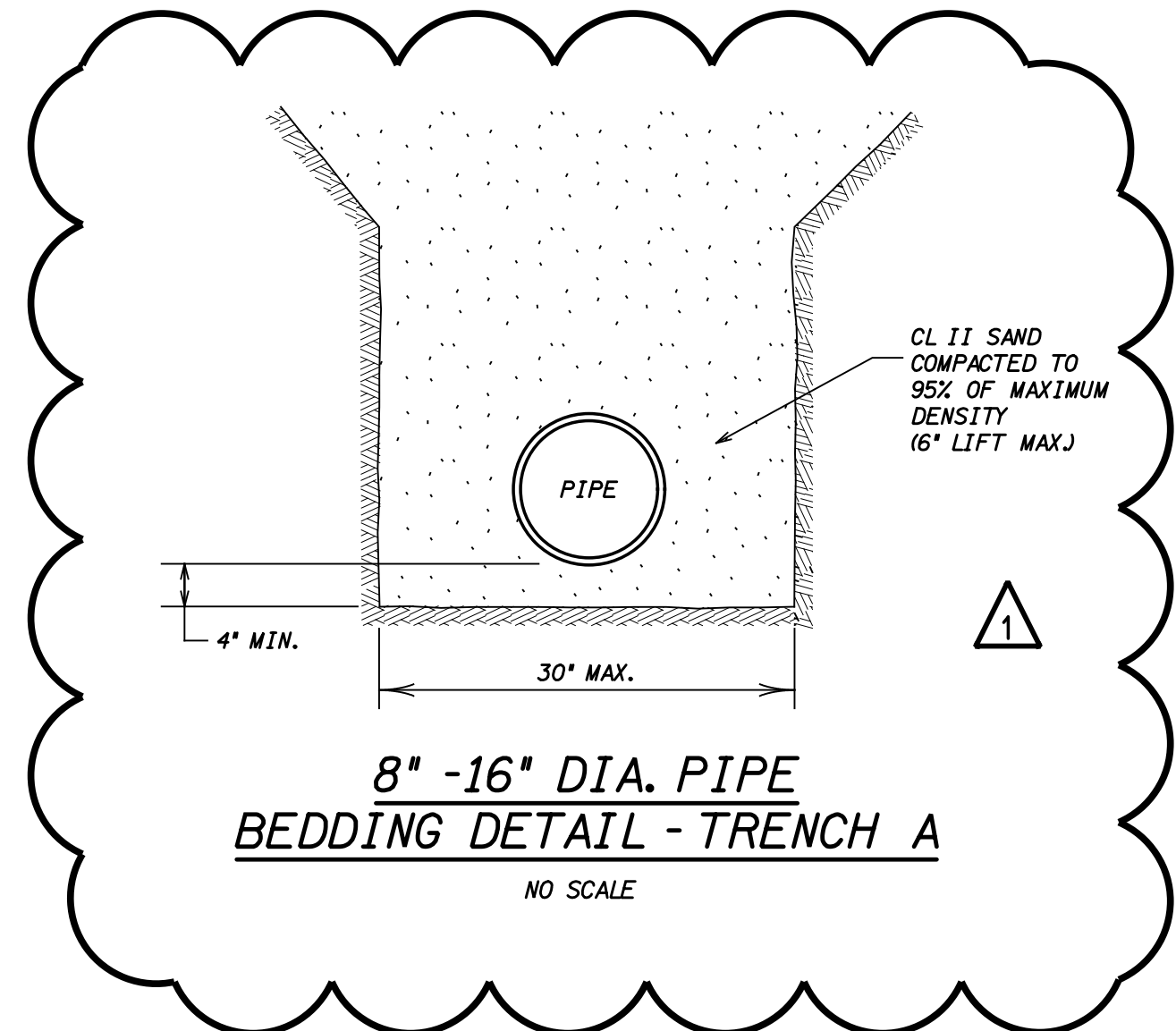

8" - 16" DIA. PIPE BEDDING DETAIL - TRENCH A
NO SCALE

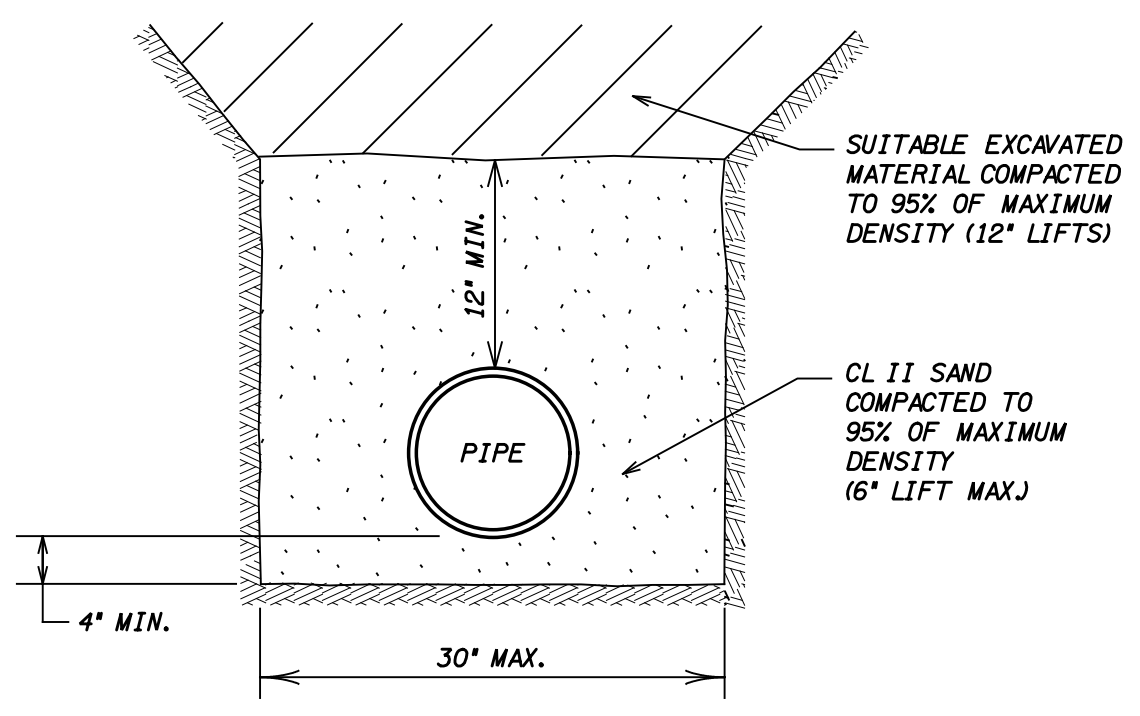

8" - 16" DIA. PIPE BEDDING DETAIL - TRENCH B
NO SCALE

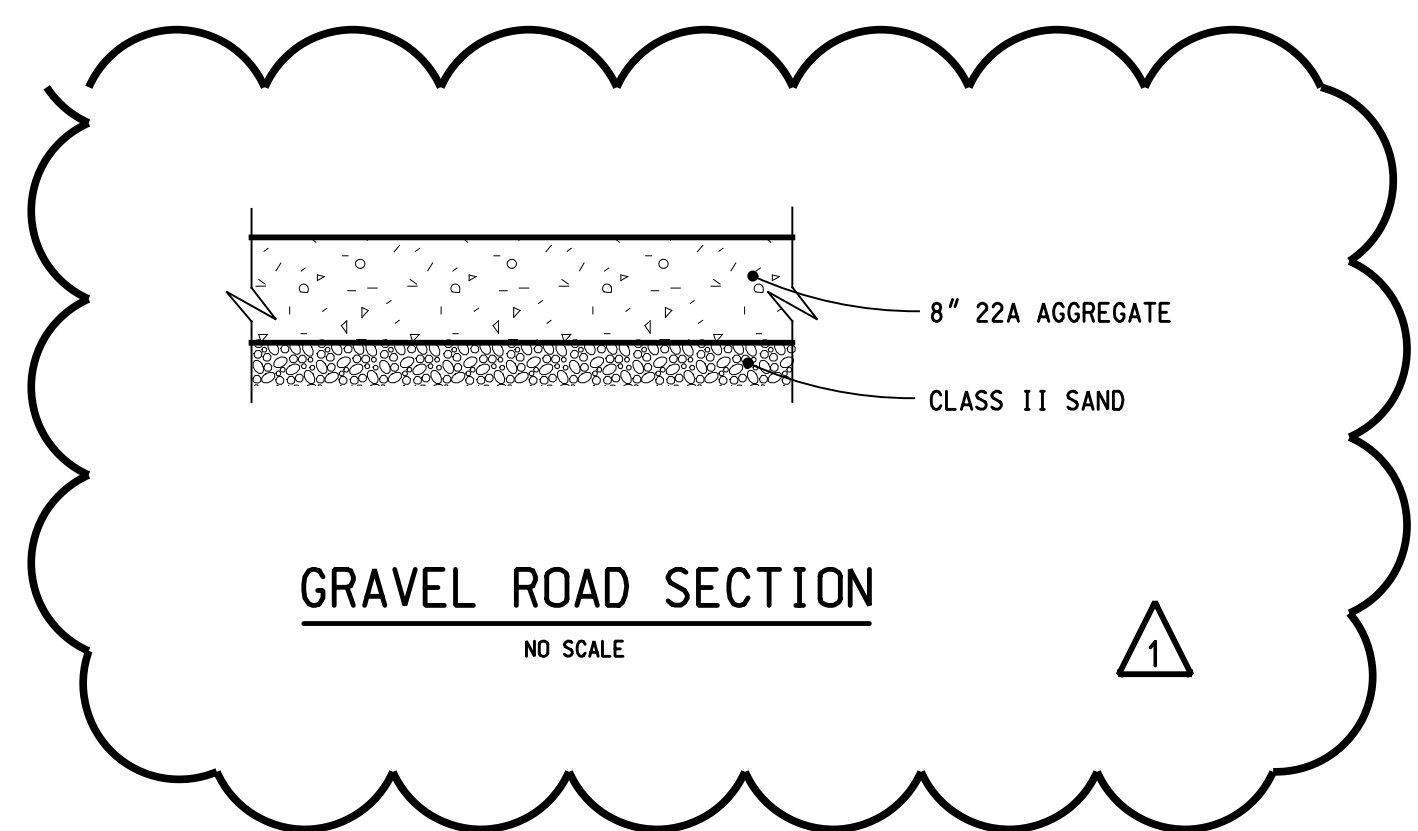

GRAVEL ROAD SECTION
NO SCALE

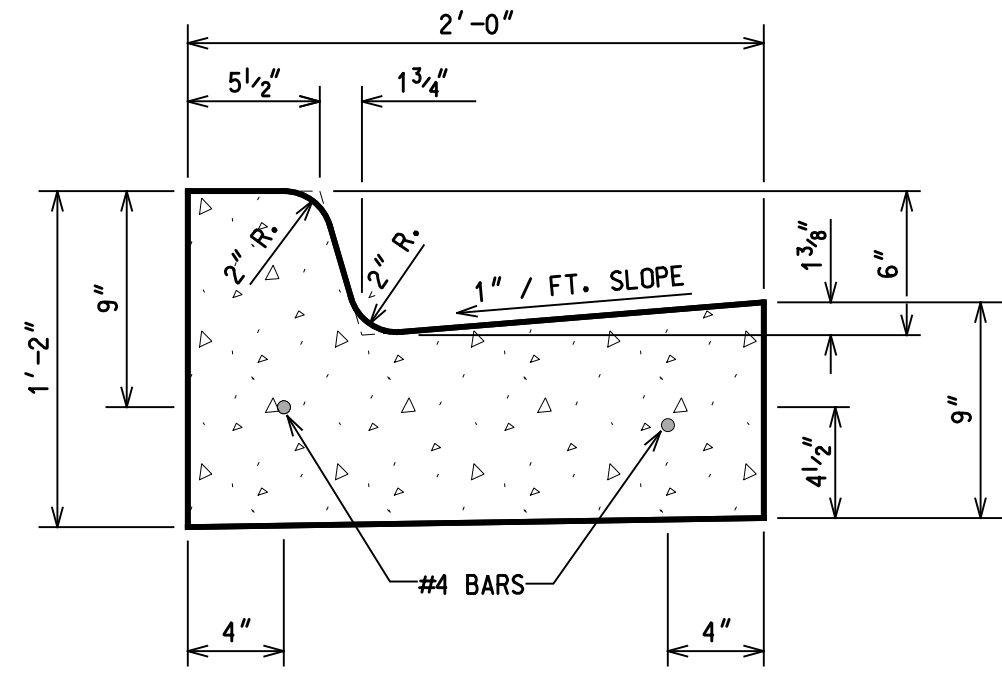

F-4 CONCRETE CURB AND GUTTER
NO SCALE

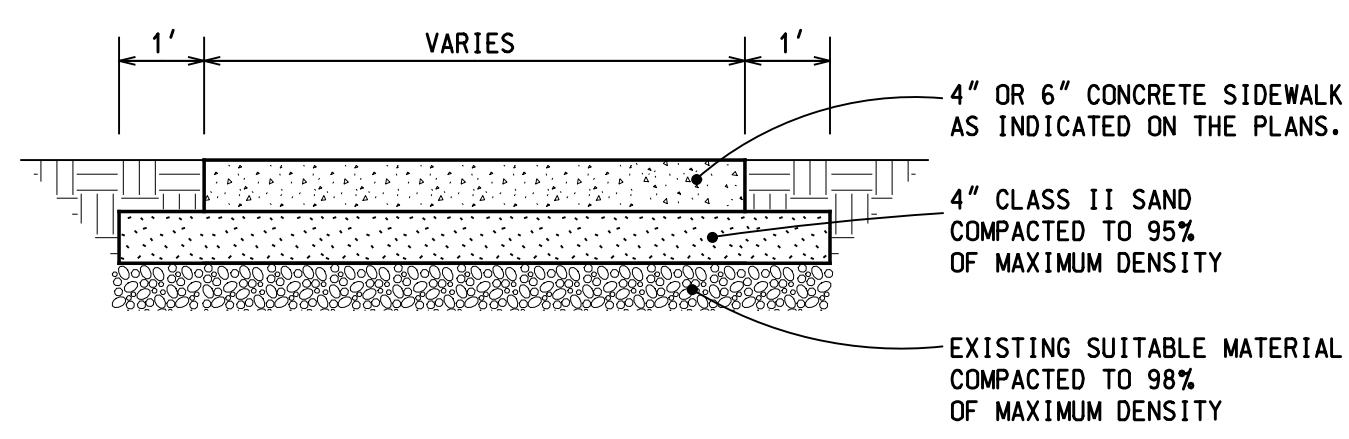

CONCRETE SIDEWALK SECTION
NO SCALE

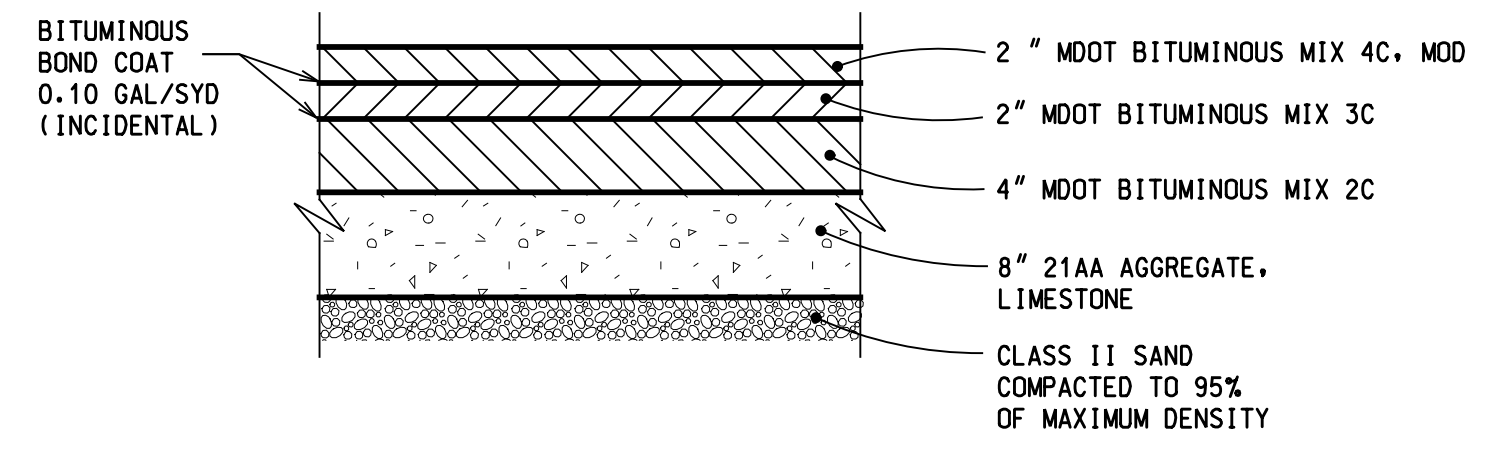

MILFORD ROAD TYPICAL DEEP STRENGTH HMA SECTION
NO SCALE

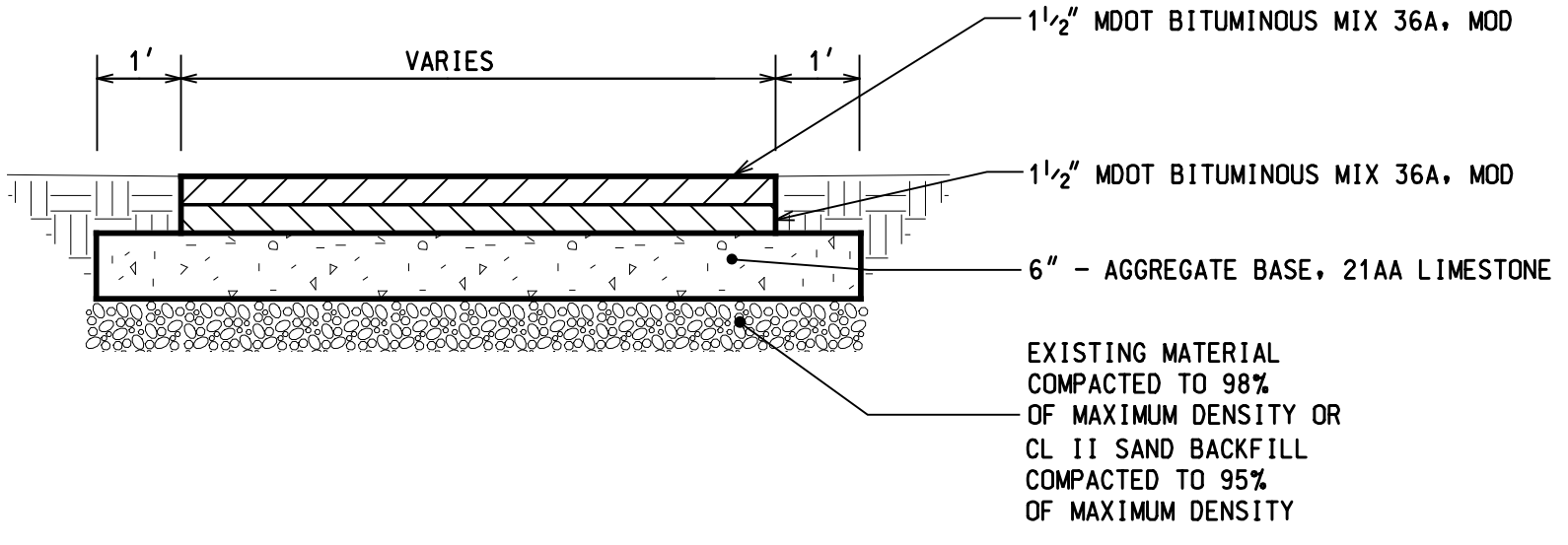

HMA SAFTY PATH AND DRIVEWAY SECTION
NO SCALE

DATE	ADDITIONS AND/OR REVISIONS
9-23-16	ADDENDUM NO. 1
9-16-16	ISSUED FOR M.D.E.Q. PERMITS
9-7-16	ISSUED FOR BIDS
8-25-16	REISSUED FOR RCOC PERMIT
8-5-16	REISSUED FOR MDT PERMIT
7-28-16	ISSUED FOR PERMITS
6-27-16	ISSUED FOR MDT PERMITS

DESIGNED	MPD/DMJ
DRAWN	DMJ
CHECKED	MPD
APPROVED	JB

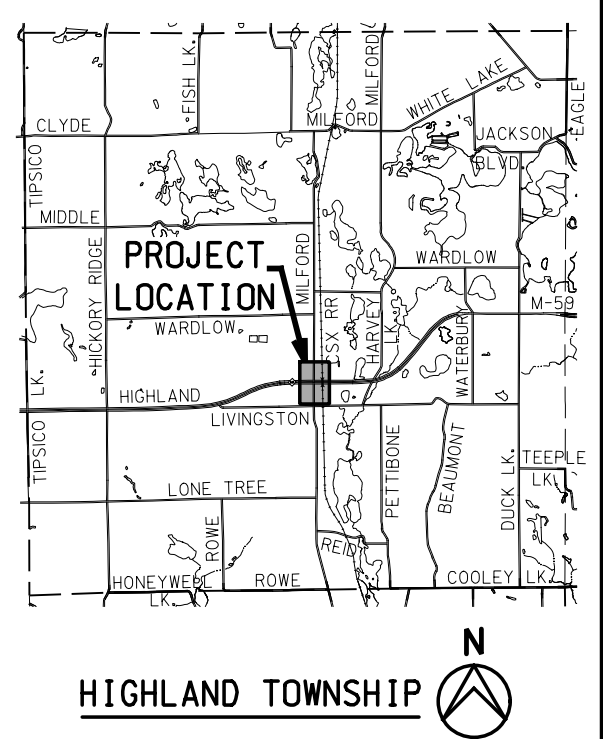

HIGHLAND TOWNSHIP
M-59 WATER MAIN CROSSING

COUNTY MICHIGAN

PROJECT DETAILS

HRC JOB NO. 20130529	SCALE NO SCALE
DATE MAY 2016	SHEET NO. 2 OF

PROPOSED WATER MAIN GATE VALVE AND HYDRANT SCHEDULE

	NORTHING	EASTING	PROPOSED ELEV.
GVW 1	416465.3505	13324898.6667	1014.53
GVW 2	416571.3101	13324887.3861	1014.48
GVW 3	416815.6824	13324919.7295	1007.53
GVW 4	416870.1442	13324946.3070	1005.85
GVW 5	417095.2882	13324937.7767	1006.99
GVW 5A	417103.9753	13324803.8284	1011.72
HYD A	416469.6280	13324892.1424	
HYD B	416861.4251	13324921.3668	

QUANTITIES THIS SHEET

ITEM	QTY	UNIT
WATER MAIN, HDPE, DR 11, 16 INCH, HDD	346	Ft
WATER MAIN, D.I. CL. 54, 16 INCH, TR DET A	475	Ft
WATER MAIN, D.I. CL. 54, 8 INCH, TR DET A	10	Ft
GATE VALVE AND WELL, 8 INCH	2	EA
GATE VALVE AND WELL, 16 INCH	4	EA
FIRE HYDRANT	2	EA

HORIZONTAL AND VERTICAL CONTROL
 HORIZONTAL CONTROL IS NAD 1983 STATE PLANE MICHIGAN SOUTH INTERNATIONAL FEET. ELEVATIONS ARE NAVD 88 DATUM.

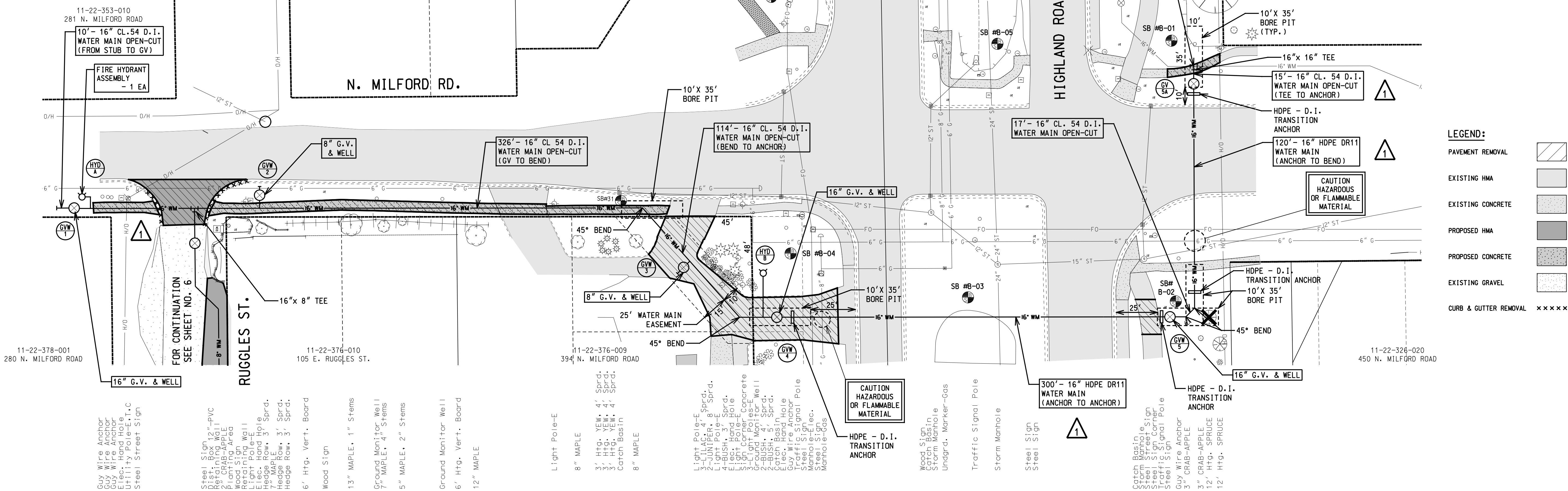

- WATER MAIN NOTES:**
- ALL WATER MAIN PIPE AND FITTINGS SHALL BE HDPE DIPS DR11, OR DUCTILE IRON CL54 (CEMENT LINED DOUBLE THICKNESS). ALL HDPE PIPE TO HAVE BLUE STRIPES AND NSF-PW PRINTED ON THE OUTSIDE.
 - ALL DUCTILE IRON PIPE, BENDS AND FITTINGS SHALL HAVE RESTRAINED JOINTS USING APPROVED SYSTEMS PER SPECIFICATIONS.
 - THRUST BLOCKS SHALL BE INSTALLED AT ALL BENDS AND FITTINGS PER OAKLAND COUNTY STANDARD WATER MAIN DETAILS.
 - CONCRETE ANCHORS FOR IN-LINE THRUST RESTRAINT SHALL BE INSTALLED AT LIMITS OF PROJECT WHERE NEW HDPE WATER MAIN IS CONNECTING TO THE EXISTING NON-RESTRAINED WATER MAIN SYSTEM.
 - CONTRACTOR TO MAKE 16 INCH WATER MAIN CONNECTION BY CUTTING IN A 16"x16" TEE. CONTRACTOR TO COORDINATE INTERRUPTION TO EXISTING BUSINESS OWNERS EFFECTED BY THE WATER MAIN SHUT DOWN. CONNECTION WILL HAVE TO TAKE PLACE AFTER HOURS OR ON WEEKENDS.

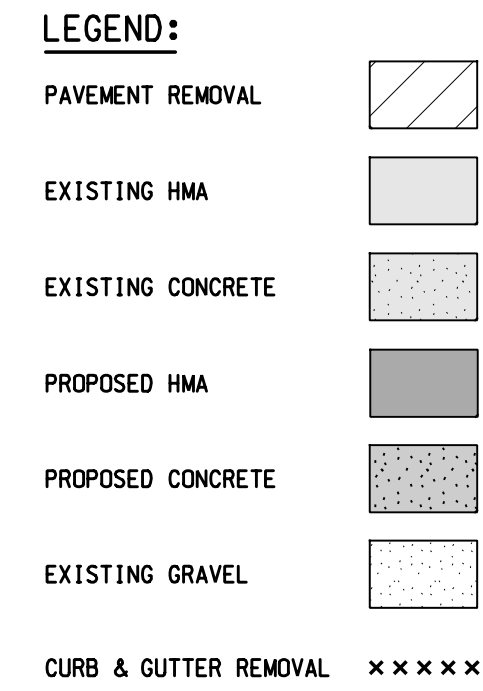

HRC
HUBBELL, ROTH & CLARK, INC
 CONSULTING ENGINEERS SINCE 1915
 105 W. GRAND RIVER AVE.
 HOWELL, MICH. 48843
 PHONE: (517) 552-9199
 FAX: (517) 552-6099
 WEB SITE: <http://www.hrc-engr.com>

DATE	ADDITIONS AND/OR REVISIONS
9-23-16	ADDENDUM NO. 1
9-16-16	ISSUED FOR M.D.E.Q. PERMITS
9-7-16	ISSUED FOR BIDS
8-25-16	REISSUED FOR RCOC PERMIT
8-5-16	REISSUED FOR MDT PERMIT
7-28-16	ISSUED FOR PERMITS
6-27-16	ISSUED FOR MDT PERMITS

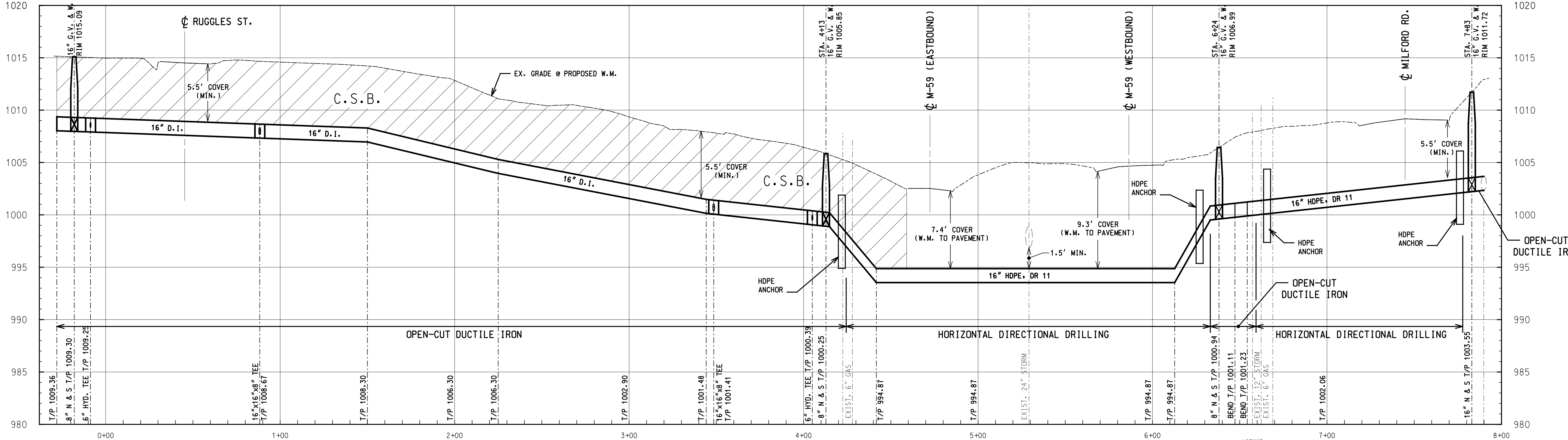
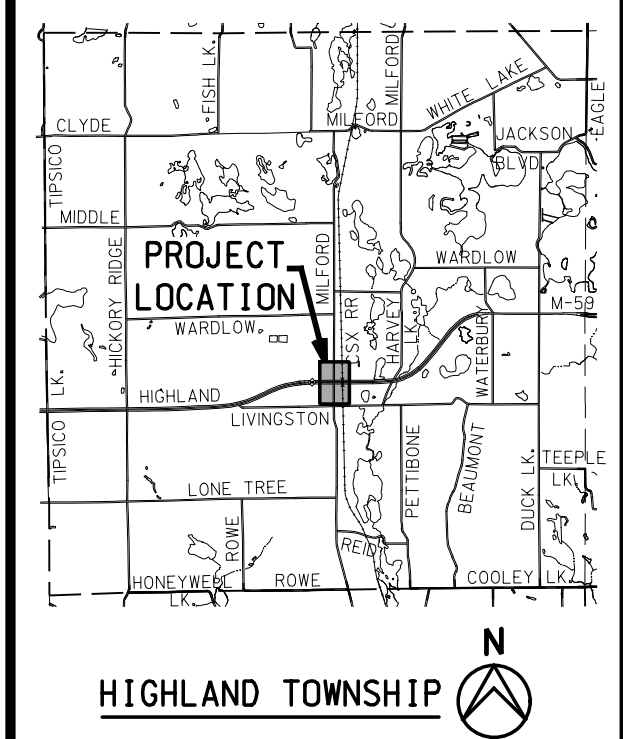

NOTICE:
 ALL EXISTING UTILITIES SHOWN ON THIS TOPOGRAPHIC SURVEY HAVE BEEN TAKEN FROM VISUAL OBSERVATION, AND RECORD MAPPING WHERE AVAILABLE. NO GUARANTEE IS MADE, OR SHOULD BE ASSUMED, AS TO THE COMPLETENESS OR ACCURACY OF THE UTILITIES SHOWN ON THIS DRAWING. PARTIES UTILIZING THIS INFORMATION SHALL FIELD VERIFY THE ACCURACY AND COMPLETENESS PRIOR TO CONSTRUCTION ACTIVITIES.

3 FULL WORKING DAYS BEFORE YOU DIG CALL MISS DIG @ 1-800-482-7171

HIGHLAND TOWNSHIP

M-59 WATER MAIN CROSSING

COUNTY: MICHIGAN

PLAN AND PROFILE SHEET

HRC JOB NO. 20130529	SCALE 1" = 30'
DATE MAY 2016	SHEET NO. 5 OF 5

USER: NAME: dJames
 DESIGN: FTTEE: W:\2013\20130529\M-59 Water Main Crossing.dwg
 DATE: 05/20/2016 10:55:41 AM
 TIME: 23:55:20
 FILE: 0710101682017.dwg



HRC HUBBELL, ROTH & CLARK, INC CONSULTING ENGINEERS SINCE 1915

105 W. GRAND RIVER AVE. HOWELL, MICH. 48843

PHONE: (517) 552-9199 FAX: (517) 552-6099

WEB SITE: http://www.hrc-enr.com

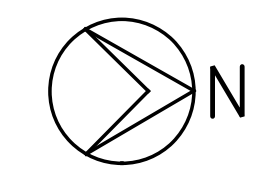

NOTE: PHYSICAL CONNECTION TO EXISTING W.M. TO BE MADE ONLY AFTER THE BACTERIOLOGICAL AND PRESSURE TESTING IS COMPLETED SUCCESSFULLY

NOTES:

- 1. CONTRACTOR SHALL BACKFILL UNDER ALL PAVEMENT AND GRAVEL ROAD, INCLUDING DRIVEWAYS AND SIDEWALKS, WITH MOTT CLASS 11 SAND AND COMPACT TO 95% DENSITY IN ONE (1) FOOT LIFTS. WATER MAIN TRENCHES WITHIN THREE (3) FEET OF THE EDGE OF PAVEMENT SHALL ALSO BE BACKFILLED WITH MOTT CLASS 11 SAND AND COMPACTED TO 95% DENSITY (INCLUDED IN THE UNIT PRICE FOR WATER MAIN).
2. ALL GATE VALVE RIM ELEVATIONS SHALL BE SET FLUSH WITH EXISTING ADJACENT LAWN AND/OR PAVEMENT GRADES (6" BELOW GRAVEL ROADS). ALL HYDRANT FINISH GRADE ELEVATIONS SHALL BE SET 6" ABOVE EXISTING ADJACENT LAWN AND/OR SIDEWALK GRADES.
3. THE DOWRC WATER DEPARTMENT WILL OPEN AND CLOSE ALL VALVES AND HYDRANTS ON EXISTING WATERMAINS. NO VALVE OR HYDRANT ON AN EXISTING WATER LINE IS TO BE OPERATED BY ANYONE OTHER THAN AN AUTHORIZED WATER DEPARTMENT EMPLOYEE. 24 HOUR NOTIFICATION IS REQUIRED.
4. CONTRACTOR TO PROTECT EXISTING MONITORING WELLS INCIDENTAL TO CONSTRUCTION.
5. CONTRACTOR TO MAKE CONNECTION TO EXISTING WATER SERVICE AT THE WELL AND DISCONNECT EXISTING WELL. PAID FOR AS WATER SERVICE CONNECTION - EA.

NOTE:

LAWN AREAS SHALL BE RESTORED WITH ALL 3" OF SCREENED TOPSOIL, FERTILIZER, SEED AND BLANKET. PROSPECTIVE BIDDERS ARE ADVISED THAT NO CLAIMS FOR EXTRA COMPENSATION WILL BE ALLOWED FOR FAILURE TO PROPERLY EVALUATE SOIL CONDITIONS AND THE EXTENT OF ANY SOIL DOWATERING THAT MAY BE NECESSARY TO PROPERLY CONSTRUCT THIS PROJECT. CONTRACTOR SHALL PROTECT ALL MAILBOXES, DECORATIVE LANDSCAPING, SPRINKLER HEADS, SIGNS, ETC. ANY DAMAGE INCURRED DURING CONSTRUCTION SHALL BE RESTORED TO EQUAL OR BETTER CONDITION PRIOR TO CONSTRUCTION. CONTRACTOR SHALL DEFLECT JOINTS PER MANUFACTURERS RECOMMENDATIONS TO MAINTAIN VERTICAL AND HORIZONTAL ALIGNMENT UNLESS OTHERWISE INDICATED ON PLANS. THE CONTRACTOR SHALL FURNISH AND PLACE THRUST BLOCKS AT ALL PLUGS, CAPS, TEES, FITTINGS, BENDS AND ELBOWS AS DIRECTED BY THE STANDARD DETAILS AND SPECIFICATIONS. ALL COSTS INCURRED SHALL BE INCLUDED IN THE UNIT PRICE BID FOR WATER MAIN

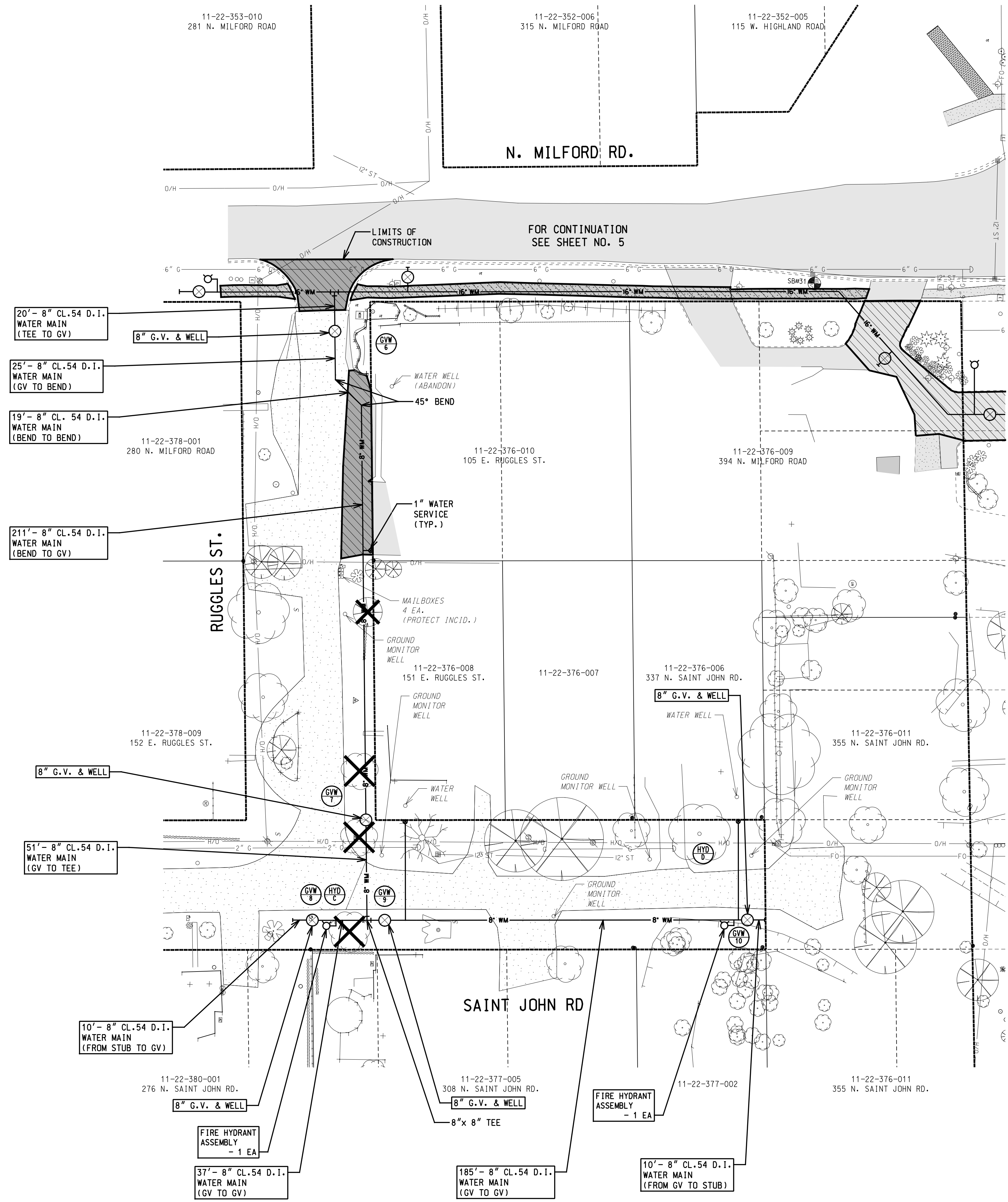

PROPOSED WATER MAIN GATE VALVE AND HYDRANT SCHEDULE table with columns for item, northing, easting, and proposed elevation.

HORIZONTAL AND VERTICAL CONTROL HORIZONTAL CONTROL IS NAD 1983 STATE PLANE MICHIGAN SOUTH INTERNATIONAL FEET. ELEVATIONS ARE NAVD 88 DATUM.

QUANTITIES THIS SHEET table with columns for item, quantity, and unit.

LEGEND:

- PAVEMENT REMOVAL (diagonal lines)
EXISTING HMA (stippled)
EXISTING CONCRETE (cross-hatched)
PROPOSED HMA (solid grey)
PROPOSED CONCRETE (dotted)
EXISTING GRAVEL (dashed)
CURB & GUTTER REMOVAL (XXXXX)

NOTE: ALL EXISTING UTILITIES SHOWN ON THIS TOPOGRAPHIC SURVEY HAVE BEEN TAKEN FROM VISUAL OBSERVATION, AND RECORD MAPPING WHERE AVAILABLE. NO GUARANTEE IS MADE, OR SHOULD BE ASSUMED, AS TO THE COMPLETENESS OR ACCURACY OF THE UTILITIES SHOWN ON THIS DRAWING. PARTIES UTILIZING THIS INFORMATION SHALL FIELD VERIFY THE ACCURACY AND COMPLETENESS PRIOR TO CONSTRUCTION ACTIVITIES.

3 FULL WORKING DAYS BEFORE YOU DIG CALL MISS DIG 1-800-482-7171

ADDENDUM NO. table listing revision dates and descriptions.

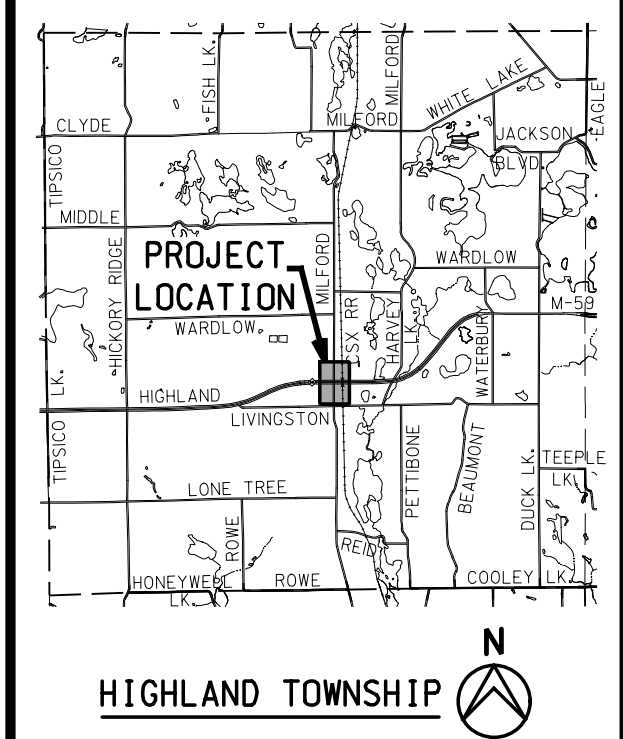

HIGHLAND TOWNSHIP M-59 WATER MAIN CROSSING

PLAN SHEET

Project metadata table including job number (20130529), date (MAY 2016), scale (1"= 30'), and sheet number (6 OF 6).